



US010674305B2

(12) **United States Patent**
York et al.

(10) **Patent No.:** **US 10,674,305 B2**
(45) **Date of Patent:** **Jun. 2, 2020**

- (54) **REMOTE MULTI-DIMENSIONAL AUDIO**
- (71) Applicant: **Microsoft Technology Licensing, LLC**, Redmond, WA (US)
- (72) Inventors: **Kendall Clark York**, Bellevue, WA (US); **Jeffrey Sipko**, Kirkland, WA (US); **Aaron Krauss**, Snoqualmie, WA (US); **Andrew F. Muehlhausen**, Seattle, WA (US); **Adolfo Hernandez Santisteban**, Bothell, WA (US); **Arthur C. Tomlin**, Kirkland, WA (US)
- (73) Assignee: **Microsoft Technology Licensing, LLC**, Redmond, WA (US)
- (*) Notice: Subject to any disclaimer, the term of this patent is extended or adjusted under 35 U.S.C. 154(b) by 0 days.

(21) Appl. No.: **15/922,515**

(22) Filed: **Mar. 15, 2018**

(65) **Prior Publication Data**
US 2019/0289416 A1 Sep. 19, 2019

(51) **Int. Cl.**
H04S 7/00 (2006.01)
H04R 5/02 (2006.01)
(Continued)

(52) **U.S. Cl.**
CPC **H04S 7/303** (2013.01); **G06F 1/163** (2013.01); **G06F 3/165** (2013.01); **G06F 3/167** (2013.01);
(Continued)

(58) **Field of Classification Search**
CPC . H04S 7/30; H04S 7/301; H04S 7/302; H04S 7/303; H04S 7/304; H04S 7/308;
(Continued)

(56) **References Cited**

U.S. PATENT DOCUMENTS

6,594,370 B1 7/2003 Anderson
8,717,406 B2 5/2014 Garcia et al.

(Continued)

FOREIGN PATENT DOCUMENTS

KR 1020090090771 A 8/2009
KR 101569121 B1 11/2015

OTHER PUBLICATIONS

“Fineck: The World’s First Wearable Device for Your Neck”, Retrieved from <<<https://web.archive.org/web/20171108082601/https://www.kickstarter.com/projects/184140387/fineck-the-worlds-first-wearable-device-for-your-n>>>, Nov. 8, 2017, 22 Pages.

(Continued)

Primary Examiner — Andrew C Flanders

(74) *Attorney, Agent, or Firm* — Holzer Patel Drennan

(57) **ABSTRACT**

The disclosed technology provides multi-dimensional audio output by providing a relative physical location of an audio transmitting device relative to an audio outputting device in a shared map of physical space shared between the audio transmitting device and the audio outputting device. An orientation of the audio outputting device relative to the audio transmitting device is determined and an audio signal received from the audio transmitting device via a communication network is processed using the determined orientation of the audio outputting device relative to the audio transmitting device and the relative physical location of the audio transmitting device to create an augmented audio signal. The augmented audio signal is output through at least one audio output on the audio outputting device in a manner indicating a relative physical direction of the audio transmitting device to the audio outputting device in the shared map of the physical space.

21 Claims, 6 Drawing Sheets

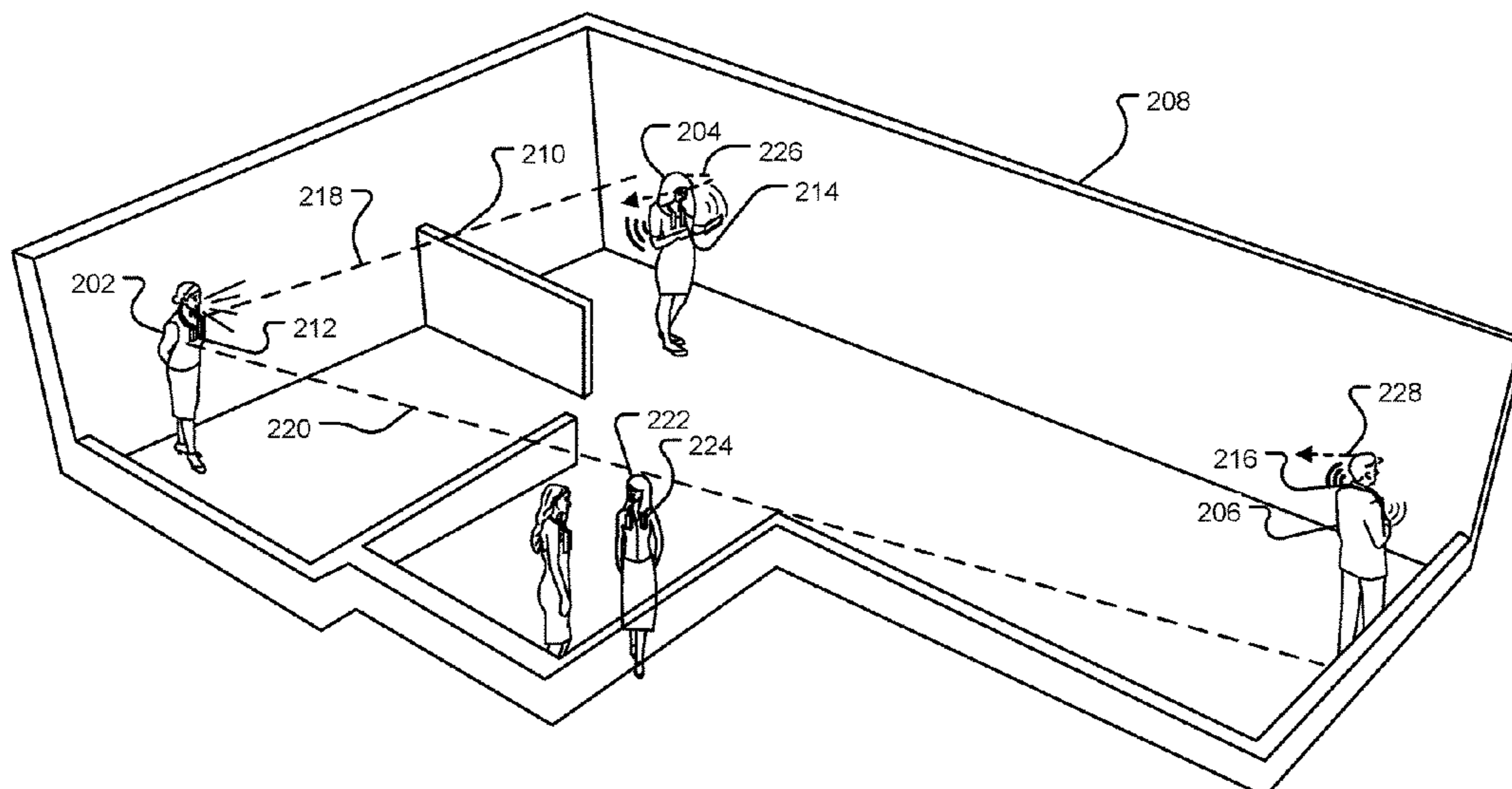

- (51) **Int. Cl.**
H04R 1/32 (2006.01)
G06F 3/16 (2006.01)
H04R 5/04 (2006.01)
H04R 3/00 (2006.01)
H04R 3/12 (2006.01)
H04R 1/40 (2006.01)
H04B 1/3827 (2015.01)
H01Q 1/27 (2006.01)
G06F 1/16 (2006.01)
G10L 15/22 (2006.01)
H04W 4/02 (2018.01)
H04R 27/00 (2006.01)
- (52) **U.S. Cl.**
 CPC *G10L 15/22* (2013.01); *H01Q 1/273* (2013.01); *H04B 1/385* (2013.01); *H04R 1/323* (2013.01); *H04R 1/403* (2013.01); *H04R 3/005* (2013.01); *H04R 3/12* (2013.01); *H04R 5/02* (2013.01); *H04R 5/04* (2013.01); *H04S 7/304* (2013.01); *H04S 7/308* (2013.01); *H04W 4/02* (2013.01); *H04W 4/023* (2013.01); *H04W 4/026* (2013.01); *G10L 2015/223* (2013.01); *H04R 27/00* (2013.01); *H04R 2420/07* (2013.01); *H04R 2460/07* (2013.01); *H04S 2400/01* (2013.01); *H04S 2400/11* (2013.01)
- (58) **Field of Classification Search**
 CPC G06F 3/012; G06F 3/013; G06F 3/165; G06F 3/167; G06F 1/163; G06F 1/3231; G06F 11/3058; G06F 11/3089; H04W 4/02; H04W 4/026; H04R 5/02; H04R 5/033; H04R 5/04; H04R 2460/07; H04R 2460/11

2014/0328505 A1 11/2014 Heinemann et al.
 2014/0369537 A1* 12/2014 Pontoppidan H04R 25/00 381/314
 2015/0063603 A1 3/2015 Henderek et al.
 2015/0100991 A1* 4/2015 Risberg H04L 67/104 725/80
 2015/0169120 A1 6/2015 Sanchez et al.
 2015/0196101 A1 7/2015 Dayal et al.
 2015/0248791 A1 9/2015 Abovitz et al.
 2015/0301592 A1* 10/2015 Miller G06F 3/011 345/156
 2015/0373477 A1* 12/2015 Norris H04M 1/72572 381/303
 2016/0080874 A1 3/2016 Fullam
 2016/0105757 A1 4/2016 Vennstrom et al.
 2016/0277647 A1 9/2016 Adachi
 2016/0379660 A1* 12/2016 Wright H04S 1/002 381/57
 2016/0381453 A1* 12/2016 Ushakov H04R 1/1033 381/71.6
 2017/0186236 A1 6/2017 Kawamoto
 2017/0318407 A1 11/2017 Meister et al.
 2018/0048976 A1* 2/2018 Kimura H04S 1/00
 2018/0116578 A1 5/2018 Tzvieli et al.
 2018/0249274 A1* 8/2018 Lyren H04S 7/303
 2018/0310116 A1 10/2018 Arteaga et al.
 2019/0289396 A1 9/2019 York et al.

OTHER PUBLICATIONS

“Multi-user for Shared iOS Devices”, Retrieved from <<https://www.mobileiron.com/sites/default/files/datasheets/files/DS_MobileIron_Multi-User_0.pdf>>, Oct. 20, 2017, 2 Pages.
 “NeckSound”, Retrieved from <<<https://web.archive.org/web/20170929222247/http://necksound.com/en/home>>>, Sep. 29, 2017, 9 Pages.
 “Personal Local Cloud Desktop Sync”, Retrieved from <<<https://web.archive.org/web/20170929124911/https://www.egnyte.com/online-storage/personal-local-cloud-features.html>>>, Sep. 29, 2017, 4 Pages.
 Angelo, et al., “SIMPLE-Use—Sensor Set for Wearable Movement and Interaction Research”, In Journal of IEEE Sensors, vol. 14, Issue 4, Apr. 2014, pp. 1207-1215.
 Stone, et al., “Technology Innovation Enabling Ecological Momentary Assessment”, In Publication of Oxford University Press, Apr. 19, 2007, 1 Page.
 “Final Office Action Issued in U.S. Appl. No. 15/922,448”, dated Aug. 23, 2018, 8 Pages.
 “Final Office Action Issued in U.S. Appl. No. 15/922,448”, dated Jan. 30, 2019, 11 Pages.
 “Non Final Office Action Issued in U.S. Appl. No. 15/922,448”, dated Apr. 11, 2019, 11 Pages.
 Patel, Darshan, “FITT360: A Feature Rich Wearable Camera to Capture 360 Degree Snaps”, Retrieved From: <https://www.nimblechapps.com/wearables/fitt360-wearable-camera-to-capture-360-degree-snaps>, Jan. 20, 2018, 4 Pages.
 “International Search Report and Written Opinion Issued in PCT Application No. PCT/US2019/021253”, dated Jun. 17, 2019, 11 Pages.
 “Final Office Action Issued in U.S. Appl. No. 15/922,448”, dated Jul. 15, 2019, 10 Pages.
 “International Search Report and Written Opinion Issued in PCT Patent Application No. PCT/US2019/021257”, dated May 23, 2019, 10 Pages.

* cited by examiner

(56) **References Cited**

U.S. PATENT DOCUMENTS

8,718,301 B1 5/2014 Jouppi et al.
 9,250,703 B2 2/2016 Hernandez-Abrego et al.
 2003/0223602 A1 12/2003 Eichler et al.
 2004/0156512 A1 8/2004 Parker
 2008/0304707 A1 12/2008 Oi et al.
 2010/0245078 A1 9/2010 Nadkarni et al.
 2010/0316232 A1 12/2010 Acero et al.
 2011/0096915 A1 4/2011 Nemer
 2011/0096941 A1 4/2011 Marzetta et al.
 2012/0214544 A1 8/2012 Shivappa et al.
 2013/0076853 A1* 3/2013 Diao H04N 7/15 348/14.08
 2013/0218456 A1* 8/2013 Zelek G01C 21/3652 701/412
 2013/0272539 A1* 10/2013 Kim G01S 3/8006 381/92
 2013/0300648 A1* 11/2013 Kim G06F 3/011 345/156
 2013/0304479 A1 11/2013 Teller et al.
 2013/0322667 A1* 12/2013 Christensen H04R 5/033 381/309
 2014/0219485 A1* 8/2014 Jensen H04R 25/405 381/313

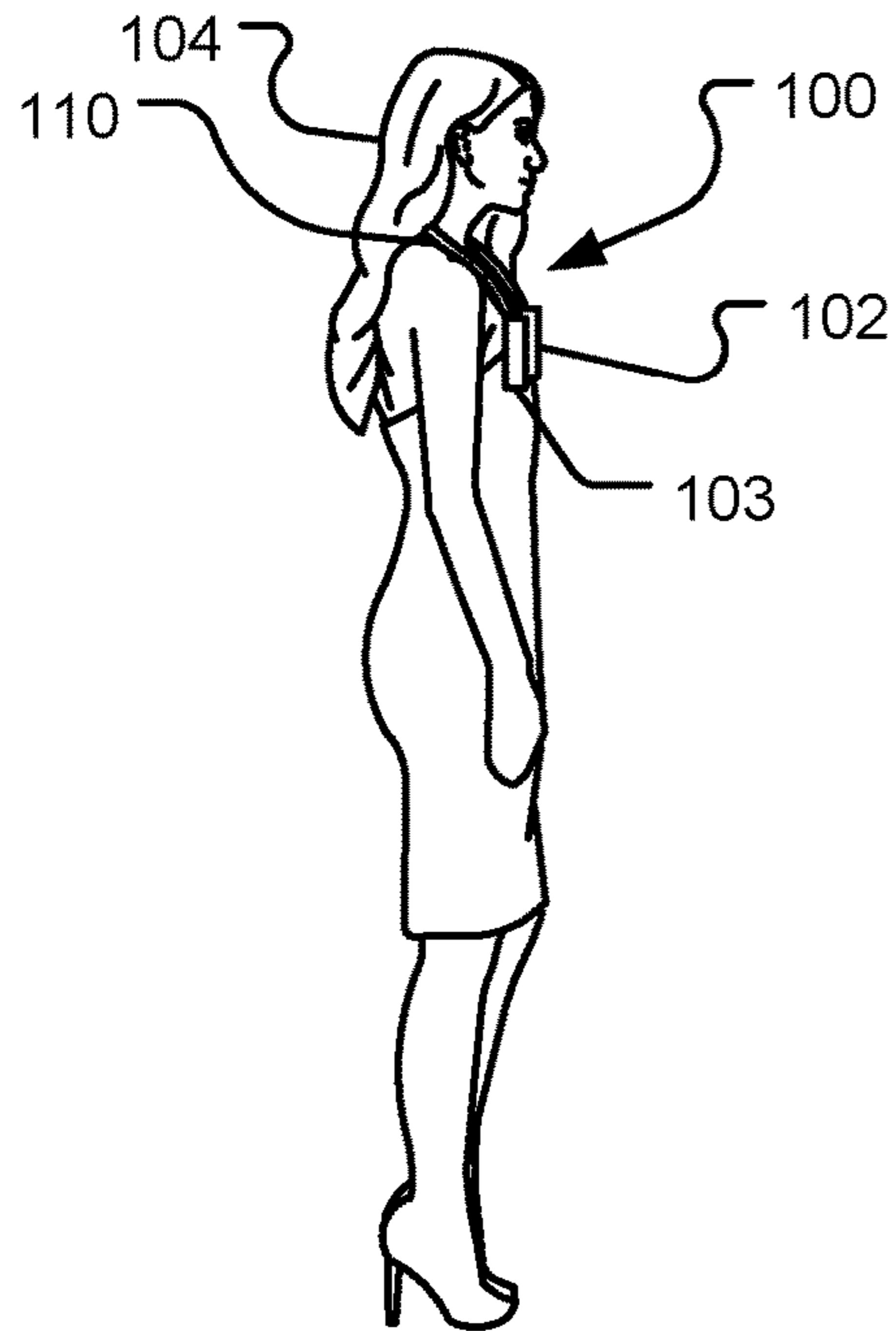

FIG. 1A

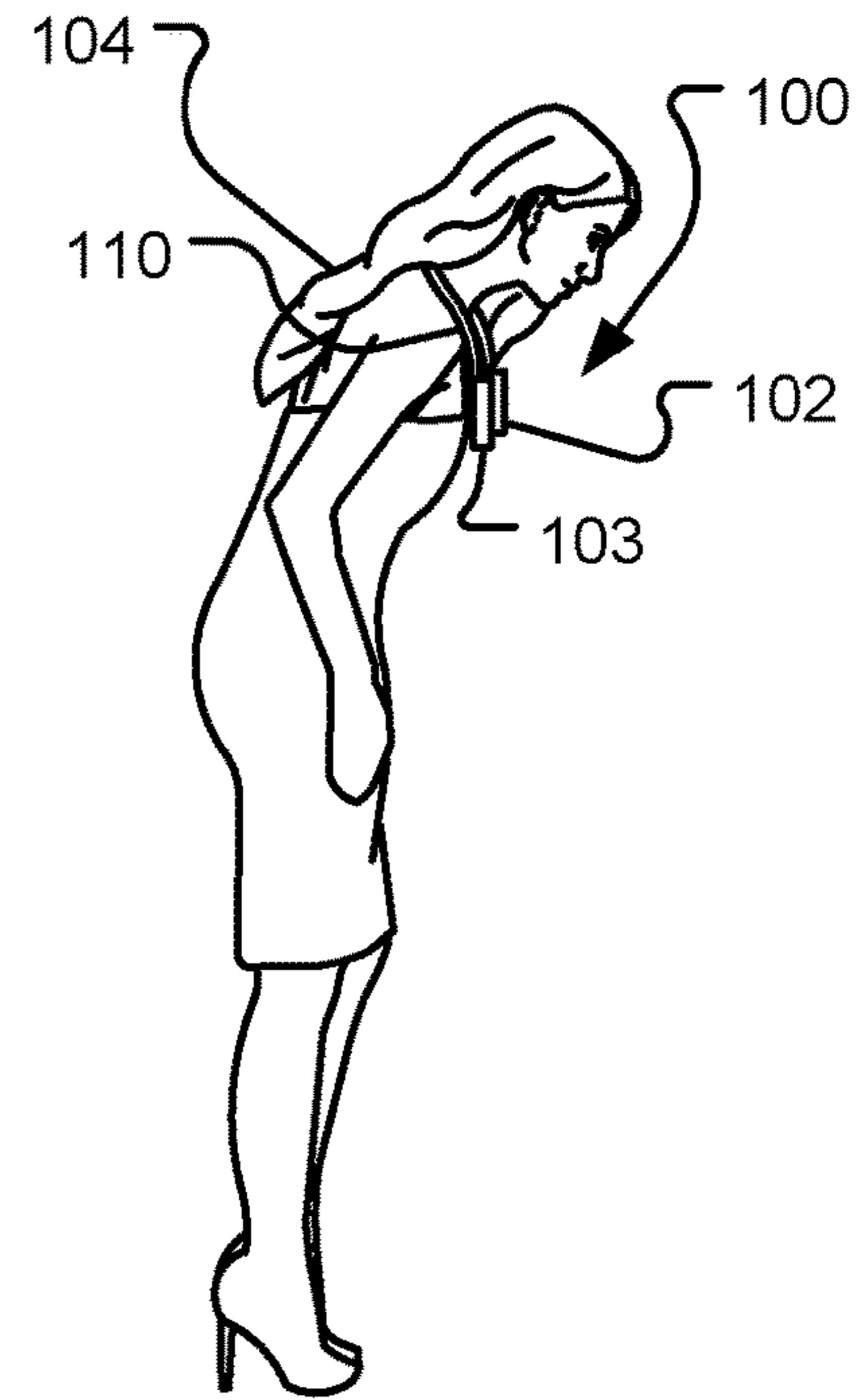

FIG. 1B

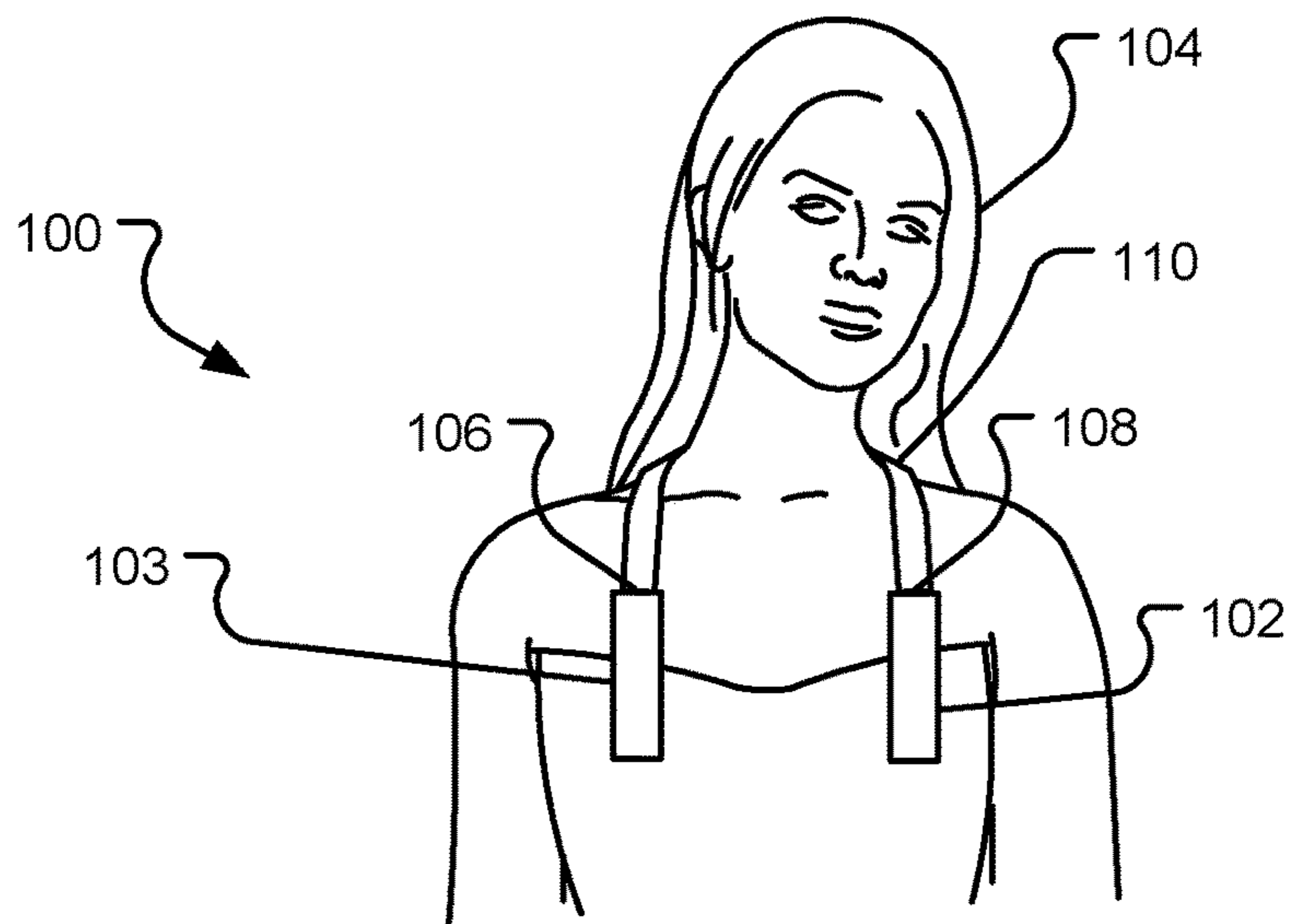

FIG. 1C

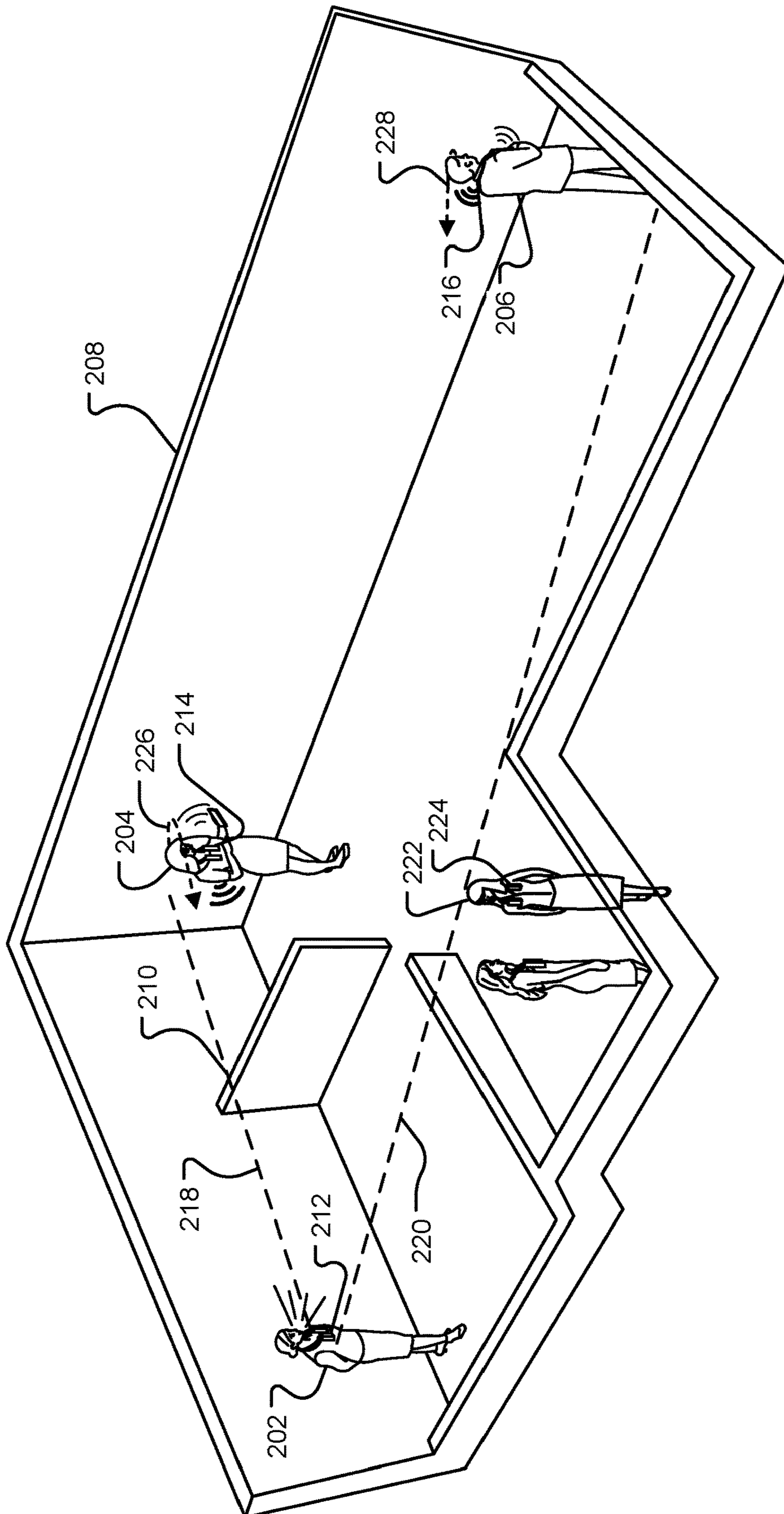

FIG. 2

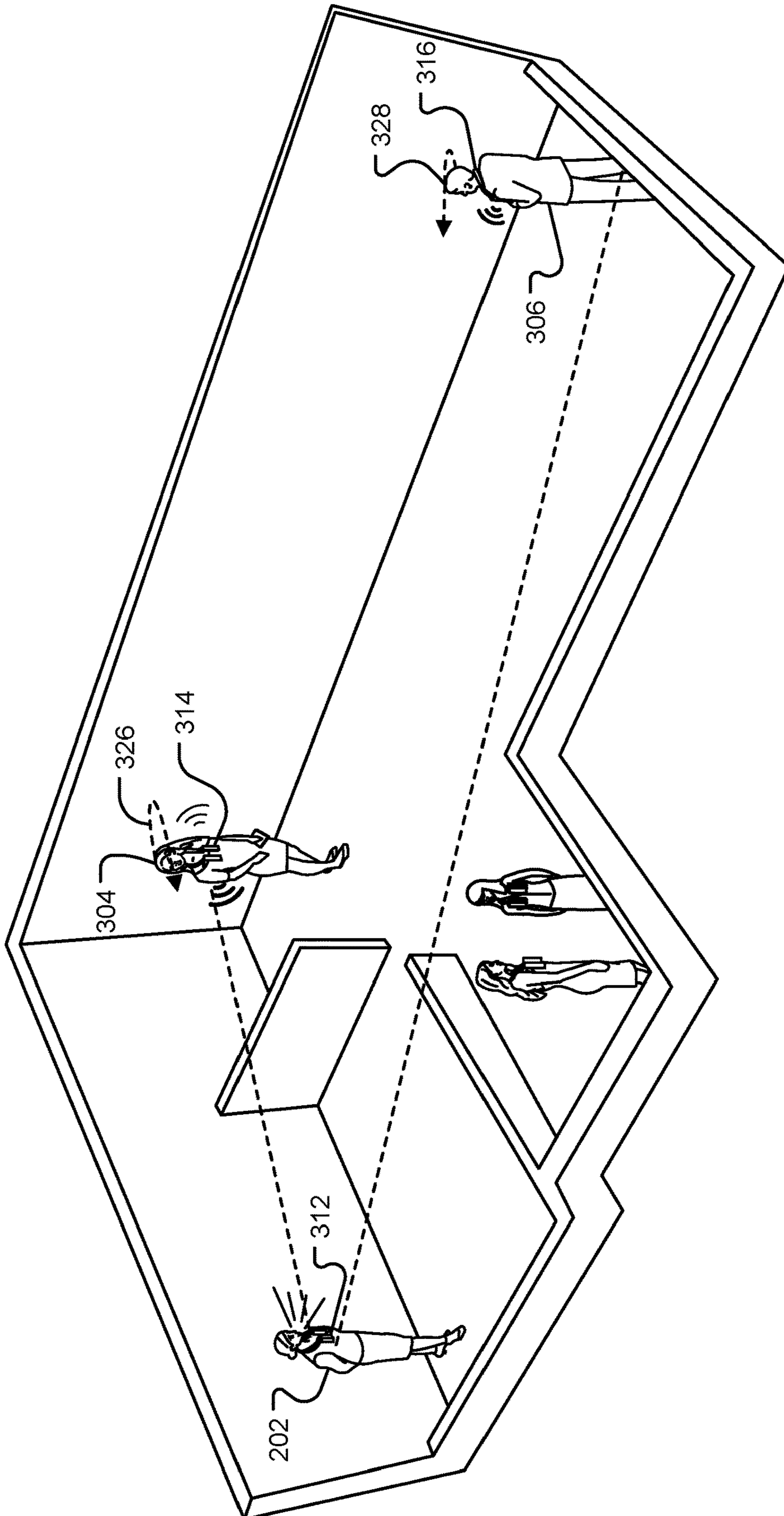

FIG. 3

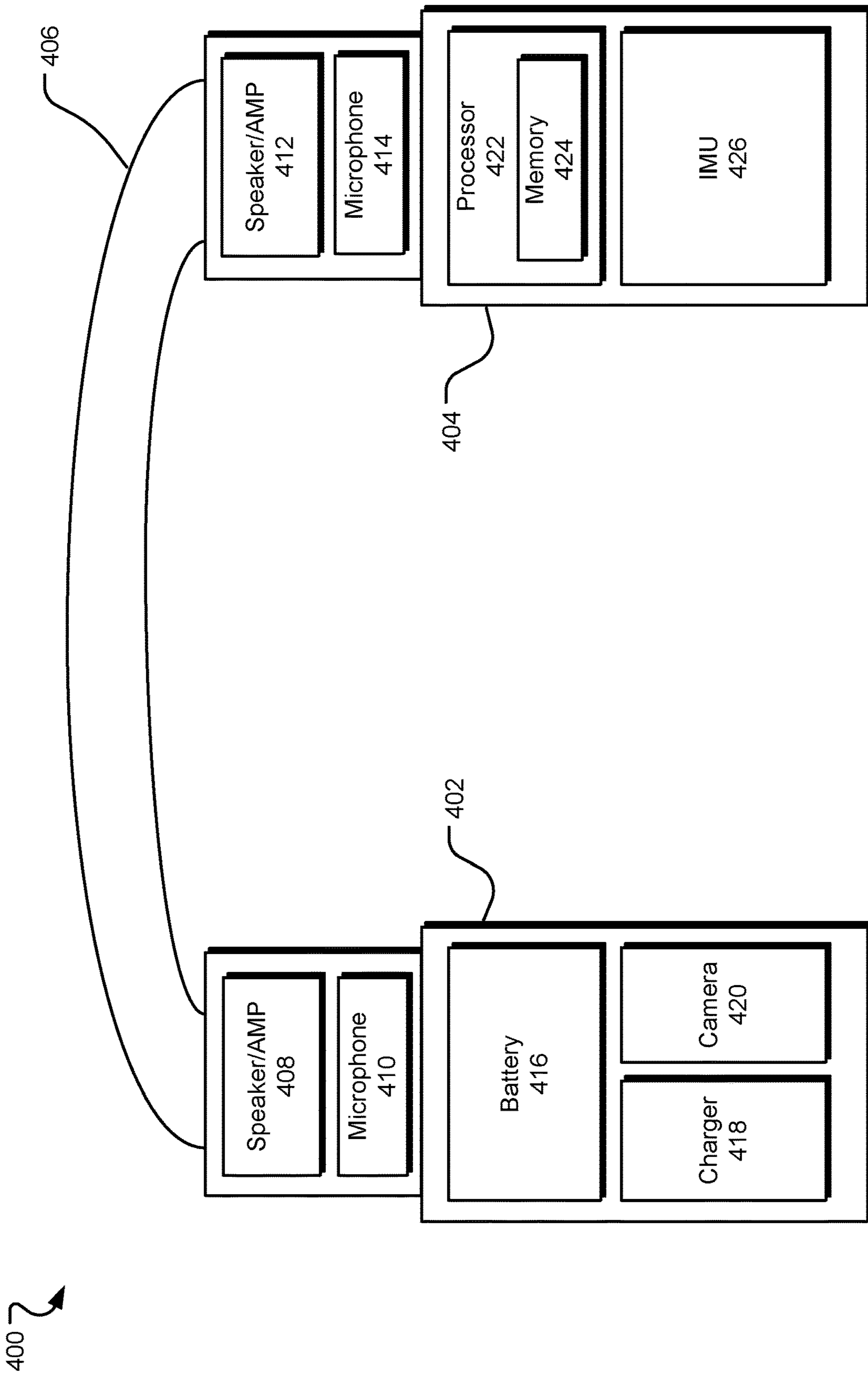

FIG. 4

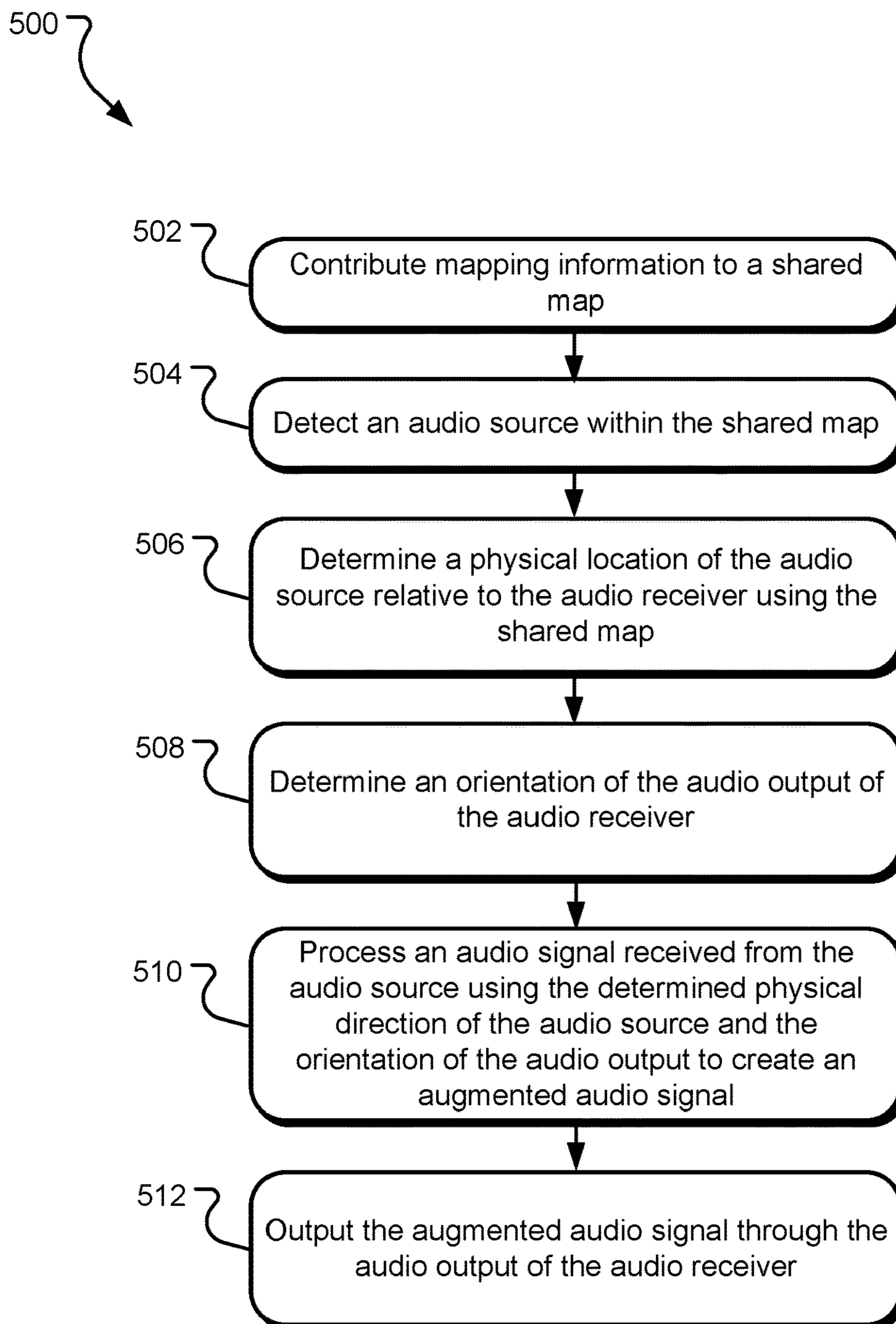

FIG. 5

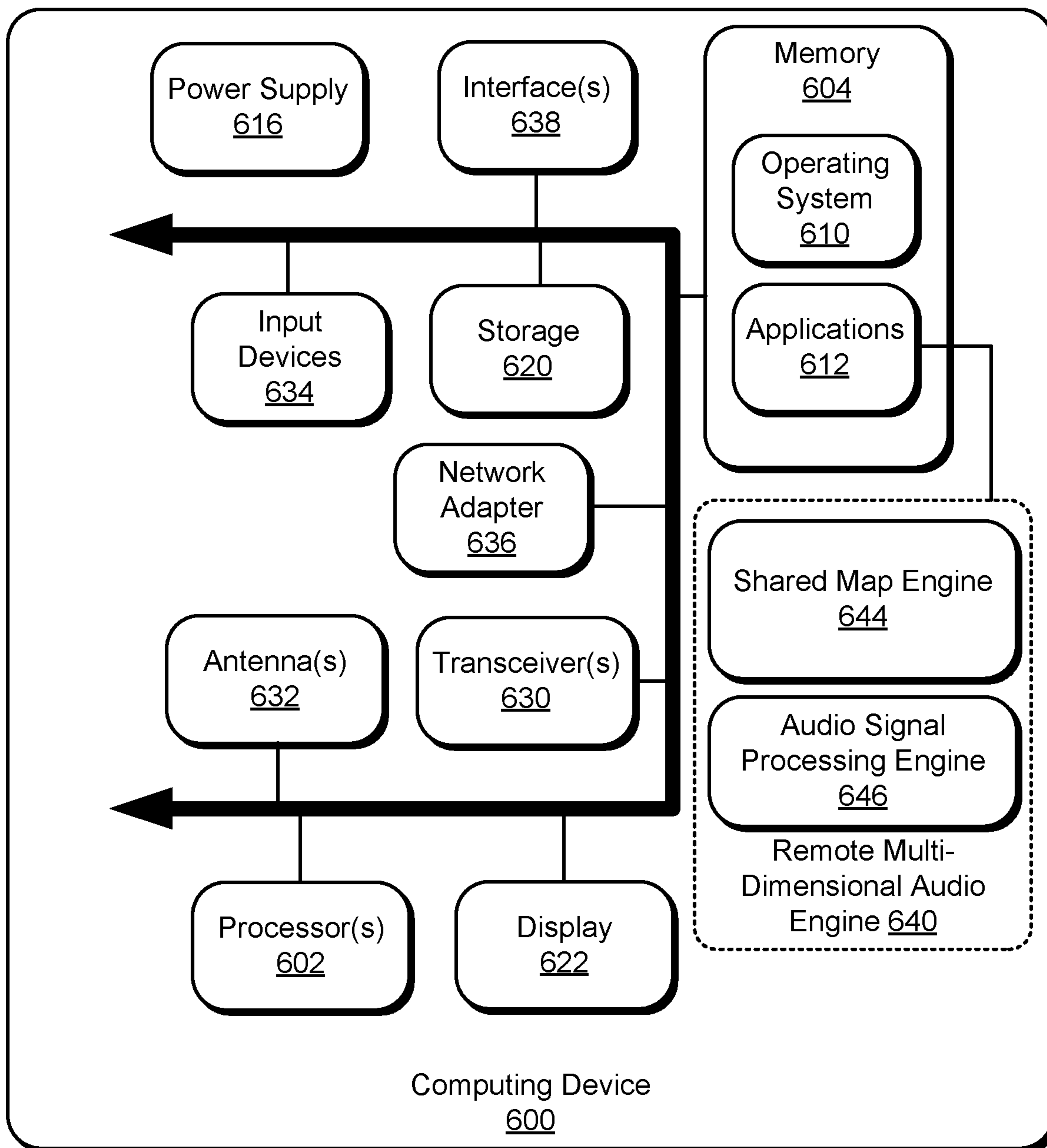

FIG. 6

REMOTE MULTI-DIMENSIONAL AUDIOCROSS-REFERENCE TO RELATED
APPLICATIONS

The present application is related to U.S. patent application Ser. No. 15/922,448, entitled "Electronic Device for Spatial Output," which is filed concurrently herewith and is specifically incorporated by reference for all that it discloses and teaches.

BACKGROUND

In crowded or busy environments, it may be difficult for people to communicate with each other due to ambient noise or structural elements, such as walls. Two-way radios and other communication devices may enable communication in crowded or busy environments. However, two-way radios and other solutions do not give the listener any indication of where the speaker is located (e.g., in which direction the speaker is relative to the listener). Further, the use of two-way radios makes it difficult for more than one person to speak at a time, often meaning that additional channels are used to allow multiple conversations to happen at once.

SUMMARY

In at least one implementation, the disclosed technology provides multi-dimensional audio output for communications between a speaker and a listener. A method provides a relative physical location of an audio transmitting device relative to an audio outputting device in a shared map of physical space. The shared map is shared between the audio transmitting device and the audio outputting device. The method further determines an orientation of the audio outputting device relative to the audio transmitting device and processes an audio signal received from the audio transmitting device via a communication network using the determined orientation of the audio outputting device relative to the audio transmitting device and the relative physical location of the audio transmitting device to create an augmented audio signal. The augmented audio signal is output through at least one audio output on the audio outputting device. The augmented audio signal is output in a manner that indicates a relative physical direction of the audio transmitting device to the audio outputting device in the shared map of the physical space.

This summary is provided to introduce a selection of concepts in a simplified form that are further described below in the Detailed Description. This summary is not intended to identify key features or essential features of the claimed subject matter, nor is it intended to be used to limit the scope of the claimed subject matter.

Other implementations are also described and recited herein.

BRIEF DESCRIPTION OF THE DRAWINGS

FIGS. 1A, 1B, and 1C illustrate an example device that provides multi-dimensional audio at an audio outputting device.

FIG. 2 illustrates an example communication providing multi-dimensional audio at two audio outputting devices.

FIG. 3 illustrates an example communication providing multi-dimensional audio at two audio outputting devices.

FIG. 4 illustrates a schematic of an example device that may be used for providing multi-dimensional audio at an audio outputting device.

FIG. 5 illustrates example operations for providing multi-dimensional audio at an audio outputting device.

FIG. 6 illustrates an example computing device for use in providing multi-dimensional audio at an audio outputting device.

DETAILED DESCRIPTIONS

In crowded environments, it may be difficult for people to communicate without the assistance of an electronic communication device. In many occupational situations, such as construction sites, retail stores, restaurants, or other large buildings, environmental factors such as noise, distances, and walls can make it difficult for members of a team to communicate effectively. Electronic communication devices alone typically do not provide the users with an indication of where communications (e.g., within the building) originate. In a large occupational setting, not knowing where a communication originates can cause confusion and decrease efficiency.

The disclosed technology provides communication between an audio transmitting device and an audio outputting device. Once the audio receiving device receives an audio communication from the audio transmitting device, the audio receiving device processes the audio signal to obtain an augmented audio signal. The processing is based on the relative location of the audio transmitting device relative to the audio receiving device. The audio receiving device presents the augmented audio signal in a manner that allows the user to determine where the communication originates. For example, the audio receiving device may present the augmented audio so that it is louder in a right side speaker and softer in a left side speaker, so it sounds like the augmented audio signal is coming from the right of the audio receiving device.

FIGS. 1A, 1B, and 1C illustrate an example audio device **100** that may be used for providing multi-dimensional audio at an audio outputting device. FIG. 1A depicts the audio device **100** in use by a user **104**. The audio device **100** includes a right electronic enclosure **103** and a left electronic enclosure **102** connected by a flexible connector **110**. In at least one implementation, the right electronic enclosure **103** and the left electronic enclosure **102** are of substantially equal weight so that the audio device **100** remains balanced around the neck of the user **104**, particularly when the flexible connector **110** slides easily on a user's neck or collar. The flexible connector **110** may include connective wires to provide a communicative connection between the right electronic enclosure **103** and the left electronic enclosure **102**. The flexible connector **110** can be draped across a user's neck, allowing the extreme ends of the right electronic enclosure **103** and the left electronic enclosure **102** to hang down from the user's neck against the user's chest. Because the audio device **100** may lie flat against the user's chest on one user but not another user, depending on the contour or shape of the user's chest, cameras in the audio device **100** may be adjustable manually or automatically to compensate for the altered field of view caused by different chest shapes and/or sizes.

FIG. 1B depicts the audio device **100** around the neck of the user **104** when the user **104** is bent over. The audio device **100** remains balanced when the user **104** bends over or moves in other directions because the right electronic enclosure **103** and the left electronic enclosure **102** are of

substantially the same weight. When the user **104** bends over, the audio device **100** continues to hang at substantially the same angle relative to the ground, so that the field of view of the cameras remains the substantially the same whether the user **104** is standing straight or bending over. In one implementation, the fields of view between standing and bending over are identical, although other implementations provide a substantial overlap in the field of views of the two states: standing and bending over. Use of a wide-angle lens or a fish-eye lens may also facilitate an overlap in the field of views. The flexible connector **110** allows the audio device **100** to hang relative to the ground instead of being in one fixed orientation relative to the chest of the user **104**.

FIG. 1C depicts the audio device **100**, that may act as both an audio transmitting device and an audio outputting device. The audio device **100** has at least one audio input and at least two audio outputs **106** and **108**. In one implementation, the audio outputs **106** and **108** are open speakers. In other implementations, the audio outputs **106** and **108** may be headphones, earbuds, headsets, or any other listening device. In at least one implementation, the audio device **100** also includes a processor, at least one camera, and at least one inertial measurement unit (IMU). In some implementations, the audio device **100** may also include other sensors, such as touch sensors, pressure sensors, or altitude sensors. Additionally, the audio device **100** may include inputs, such as haptic sensors, proximity sensors, buttons or switches. The audio device **100** may also include additional outputs, for example, without limitation, a display or haptic feedback motors. Though the audio device **100** is shown in FIG. 1 being worn around the neck of a user **104**, the audio device **100** may take other forms and may be worn on other parts of the body of the user **104**. As shown in FIG. 1C, the audio outputs **106** and **108** are located on the audio device **100** so that the audio output **106** generally corresponds to one ear of the user **104** and the audio output **108** generally corresponds to the other ear of the user **104**. The placement of the audio outputs **106** and **108** allows for the multi-dimensional audio output. Additional audio outputs may also be employed (e.g., another speaker hanging at the user's back).

FIG. 2 illustrates an example communication providing multi-dimensional audio at two audio outputting devices **214** and **216**. A speaker **202** is communicating with a listener **204** and a listener **206** within a room **208**. The speaker **202** is separated from the listener **204** and the listener **206** by a wall **210**. To communicate with each other within the room **208**, the speaker **202** is wearing the audio device **212**, the listener **204** is wearing the audio device **214**, and the listener **206** is wearing the audio device **216**. Each of the audio device **212**, the audio device **214**, and the audio device **216** may function as both an audio outputting device and an audio transmitting device in some implementations. In FIG. 2, the audio device **212** is functioning as an audio transmitting device, while the audio device **214** and the audio device **216** are functioning as audio outputting devices.

Without the assistance of the audio devices **212**, **214**, and **216**, the wall **210** may prevent the speaker **202** from speaking to the listener **204** and the listener **206** without an assistive device. Using the method of providing multi-dimensional audio to the audio devices **214** and **216** acting as audio outputting devices, the listener **204** may hear speaker **202** through the audio device **214**, and the listener **206** may hear speaker **202** through the audio device **216**. The multi-dimensional audio output means that the audio device **214** and the audio device **216** will have different audio outputs because each device is located in a different place relative to the audio device **212**. For example, the audio

device **214** may output the received audio at a higher volume from a left side speaker of the audio device **214** to indicate that the speaker **202** is to the left of the listener **204**. Similarly, the audio device **216** may output the received audio at a higher volume from a right side speaker of the audio device **216** to indicate that the speaker **202** is to the right of the listener **206**. This multi-dimensional output allows the listener **204** and the listener **206** to be aware of where the transmitted audio is coming from, within the room **208**. In some implementations, the audio may be output in three-dimensional audio, providing an additional indication of the source of the transmitted audio.

To determine their location relative to one another, the audio devices **212**, **214**, and **216** continuously contribute to a shared map of the room **208**. In one implementation, the shared map is based on position sensors in each device. The position sensors may be, for example, GPS sensors or sonar sensors. In another implementation the audio devices **212**, **214**, and **216** each include beacons that communicate with external sensors placed around a physical location (e.g., a building or large room) to provide fine resolution location data to complement or substitute GPS information so as to determine the very detailed and accurate locations of the audio devices **212**, **214**, and **216** within the shared map.

In another implementation, when the audio devices are used indoors, a shared map may be created using the cameras on each device and shared feature points. For example, a camera in the audio device may locate the corners of the wall **210** or of the outer walls of the room **208**. An orientation sensor in the audio device can detect the orientation of the audio device relative to the shared feature points, substantially in real time, and pass this orientation information to the processor of the audio device. While the orientation sensor provides information about how the audio device has moved, the cameras continue to capture reference points. The orientation sensor may be an inertial measurement unit (IMU). The location of the audio device relative to the shared feature points may then be calculated and contributed to the shared map. Over time, the shared map becomes more robust, with each audio device in a space (e.g., audio devices **212**, **214**, and **216**) continuously contributing information about its location relative to shared feature points.

The audio devices **212**, **214**, and **216** may use simultaneous location and mapping (SLAM) to calculate the location of the audio device relative to shared feature points. The location of the audio device relative to a shared feature point may be calculated using two images of the shared feature point captured by a camera on the audio device and an estimated distance traveled by the camera during the time elapsed between the two images. The orientation sensor provides the acceleration of the camera during the time elapsed between the two images. By taking the double integral of the acceleration of the camera, a rough estimate for the distance traveled by the camera may be obtained. Over time, with enough captured data, the rough estimates for distance traveled can provide an accurate shared map.

When the speaker **202** speaks, the audio device **212** picks up the audio. The audio may be transmitted over a shared communication network (e.g., a Wi-Fi network, a cellular network, or any other method of wireless communication) to audio devices **214** and **216**, acting as audio outputting devices. In one implementation, shown in FIG. 2, the audio device **212** only transmits audio to audio outputting devices within a transmission zone (shown in FIG. 2 as the area between a broken line **218** and a broken line **220**).

The area included in the transmission zone of the audio device **212** may be predetermined or may be a setting that a user of the audio device **212** may adjust to meet specific needs. In another implementation, the transmission zone of the audio device **212** may be automatically adjusted by the audio device **212** based on environmental characteristics of the area (e.g., the transmission zone may get smaller when the area is more crowded or noisy). The transmission zone allows the speaker **202** to transmit audio to audio outputting devices in a certain area, while not disturbing audio devices outside of the certain area. For example, the speaker **202** may wish to ask for something to be brought from the back of the room **208**, where listener **204** and listener **206** are located. A listener (e.g., a listener **222**), outside of the transmission zone wearing an audio device (e.g., an audio device **224**) will not receive audio from the audio device **212**. The transmission zone may change depending on which direction the speaker **202** is facing (or the orientation of the speaker's audio device **212**). For example, if the speaker **202** wanted to transmit audio to the listener **206** and the listener **222**, the speaker **202** may turn to the right, shifting the transmission zone enclosed by the broken lines **218** and **220**.

In other implementations, the speaker **202** may select which listeners receive the transmitted audio through verbal or other commands to the audio device **212**. For example, if the speaker **202** wishes to transmit audio only to coworkers in a certain department, the speaker **202** may say the name of the department to select listeners before speaking. In some implementations, the speaker **202** may be able to select individual listeners using this method, excluding other listeners from receiving the audio signal over the communications network. Nonverbal commands, such as specific gestures to a camera located on the audio device **212**, may also be used to select listeners.

The shared map is used by the audio devices **212**, **214**, and **216** to provide multi-dimensional audio output based on where the audio devices **212**, **214**, and **216** are located. After the speaker **202** selects which audio devices will receive the audio output of the audio device **212** and transmits the audio output over the communication network, the audio devices **214** and **216**, acting as audio outputting devices, determine their relative location relative to the audio device **212**. The relative location of the audio device **214** relative to the audio device **212** indicates the distance between a center point of the audio device **214** and a center point of the audio device **212**. Similarly, the relative location of the audio device **216** relative to the audio device **212** indicates the distance between a center point of the audio device **216** and the center point of the audio device **212**.

When the audio devices **212**, **214**, and **216** each continuously contribute mapping information to the shared map, the shared map accumulates information about a shared space. Each of the audio devices **212**, **214**, and **216** use the shared map to determine the audio device's location on the shared map. Each of the audio devices **212**, **214**, and **216** then shares its location to a shared simulation. The shared simulation includes the shared information about the location of each of the audio devices **212**, **214**, and **216** within a shared space. The audio device **214** may use information from the shared simulation about the location of the audio device **212** within the shared space and information about the location of the audio device **214** within the shared space to calculate the relative location of the audio device **212** to the audio device **214**. Similarly, the audio device **216** may use information from the shared simulation about the location of the audio device **212** within the shared space and information about the location of the audio device **216** within the shared

space to calculate the relative location of the audio device **212** to the audio device **216**. The shared simulation may be implemented using a client-server model or a peer-to-peer model.

The audio devices **214** and **216** also determine their relative orientation to the audio device **212**. The relative orientation of the audio device **214** to the audio device **212** provides more information about the angle between the audio device **214** and the audio device **212**. While the relative location between the audio device **214** and the audio device **212** provides the angle between the center point of the audio device **214** and the center point of the audio device **212**, the relative orientation between the audio device **214** and the audio device **212** indicates the angle between the audio device **214** and the audio device **212**. An axis of an audio device is roughly aligned with the ears of the listener. The angle of the axis indicates the orientation of the audio device. In one implementation, IMUs in the audio devices **212**, **214**, and **216** may provide information about the orientation of each of the audio devices **212**, **214**, and **216** respectively. In another implementation, external sensors detecting each of the audio devices **212**, **214**, and **216** may provide information about each of the audio devices **212**, **214**, and **216**, respectively. Information about the orientations of the audio devices **212**, **214**, and **216** may be contributed to the shared map by each of the audio devices **212**, **214**, and **216**. When the audio device **214** determines the relative orientation of the audio device **214** to the audio device **212**, it may use the information contributed to the shared simulation in its determination.

In one implementation, a receiving angle and a transmission angle are calculated. The receiving angle is the angle between a forward vector of the audio device **214** (or the audio device **216**) and the center point of the audio device **212**. The transmission angle is the angle between a forward vector of the audio device **212** and a center point of the audio device **214** (or the audio device **216**). When a transmission is triggered by the audio device **212**, each of the audio device **212**, the audio device **214**, and the audio device **216** perform calculations to calculate the receiving angle and the transmission angle. The receiving angle and the transmission angle are used to determine whether the audio device **214** and the audio device **216** meet transmission criteria. For example, the transmission criteria may be the transmission area defined by the broken line **218** and the broken line **220**. If the transmission angle determines that an audio device is outside of the transmission area, the audio device outside of the transmission area will not produce any sound. If, as is the case for the audio device **214** and the audio device **216**, the audio device is inside the transmission area (or the audio device meets another transmission criteria), the receiving angle is calculated, and transmission continues.

After the audio devices **214** and **216** determine their relative location from the audio device **212** and their relative orientation relative to the audio device **212**, the audio devices **214** and **216** process the audio signal from the audio device **212** using the relative location and relative orientation to create an augmented audio signal for each audio device. Each audio device **214** and **216** outputs its augmented audio signal to adjust the relative magnitude/timing of audio outputs from each speaker of the audio devices to indicate where, physically, the audio signal originated. For example, in FIG. 2, the audio device **214** outputs the audio at a higher volume from the left speaker of the audio device **214**, to indicate that the audio device **212** acting as an audio transmitting device is to the left of the audio device **214**. Similarly, the audio device **216** outputs the audio at a higher

volume from the right speaker of the audio device **216**, to indicate that the audio device **212** acting as an audio transmitting device is to the right of the audio device **216**. The augmented audio signal may be processed using a head-related transfer function based on the relative location and orientation of an audio device acting as an audio outputting device relative to an audio device acting as an audio transmitting device. In some implementations, the processing may occur directly on the audio device **214** or on the audio device **216**. In other implementations, the processing may occur on another computing device communicatively connected to the audio device **212**, the audio device **214**, and the audio device **216** through a communication network (e.g., the cloud, a cellular network, or WIFI).

The augmented audio signal may be output from the audio device **214** and the audio device **216** using, for example, without limitation, open speakers, headsets, earbuds, or any other type of headphones or listening device. In some implementations, more than two audio outputs may exist on each audio device, to provide the user with further guidance about the direction of the sound. An arrow **226** shows the direction that the listener **204** will turn in response to audio output from the audio device **214**. An arrow **228** shows the direction that the listener **206** will turn in response to audio output from the audio device **216**.

FIG. **3** illustrates an example communication providing multi-dimensional audio at audio outputting devices **314** and **316**. audio signal is received from an audio transmitting device **312** and is processed by the audio outputting devices **314** and **316** to output an augmented audio signal based on the relative location and orientation of the audio transmitting device **312** relative to the audio outputting devices **314** and **316**. The augmented signal is output by the audio outputting devices **314** and **316** differently based on the relative location and orientation of the audio transmitting device **312**. For example, because the audio transmitting device **312** is to the left of the audio outputting device **314**, the augmented audio signal is presented so that it is louder from the left speaker of the audio outputting device **314**. Similarly, because the audio transmitting device **312** is to the right of the audio outputting device **316**, the augmented audio signal is presented so that it is louder from the right speaker of the audio outputting device **316**. In response to the output audio signal from the audio outputting device **314**, a listener **304** turns in the direction of an arrow **326**, towards a speaker **302**. Similarly, in response to the audio output from the audio outputting device **316**, a listener **306** turns in the direction of an arrow **328**, also towards the speaker **302**.

FIG. **4** illustrates a schematic of an example device **400** that may be used for providing multi-dimensional audio at an audio outputting device. The device **400** includes a left electronic enclosure **402** and a right electronic enclosure **404** connected by a flexible connector **406**. In the illustrated implementation, the flexible connector **406** includes wiring or other connections to provide power and to communicatively connect the left electronic enclosure **402** with the right electronic enclosure **404**, although other implementations may employ wireless communications, a combination of wireless and wired communication, distributed power sources, and other variations in architecture. The left electronic enclosure **402** and the right electronic enclosure **404** are substantially weight-balanced to prevent the device **400** from sliding off a user's neck unexpectedly. In some implementations, the electronic components and the left electronic enclosure **402** weigh substantially the same as the electronic components and the right electronic enclosure **404**. In other implementations, any type of weight or re-distributed may

be added to either the left electronic enclosure **402** or the right electronic enclosure **404** to balance the weights of the left electronic enclosure **402** and the right electronic enclosure **404**.

In the device **400** of FIG. **4**, the left electronic enclosure **402** includes a speaker **408** and a microphone **410**. The right electronic enclosure **404** also includes a speaker **412** and a microphone **414**. The speaker **408** may be calibrated to deliver audio to the left ear of a user while the speaker **412** may be calibrated to deliver audio to the right ear of a user. In some implementations, the speaker **408** and the speaker **412** may be replaced with earbuds or other types of headphones to provide the audio output for the device **400**. The microphone **410** and the microphone **414** receive audio from the user of the device **400**. In some implementations, there may be only one microphone on the device **400**. In other implementations, an external microphone, such as a microphone integrated with a set of headphones, may be included in place of the microphone **410** and the microphone **414**.

The left electronic enclosure **402** further includes a battery **416**, a charger **418**, and a camera **420**. The charger **418** charges the battery **416** and may have a charging input or may charge the battery through proximity charging. The battery **416** may be any type of battery suitable to power the device **400**. The camera **420** provides a wide field of view through use of a wide angle or fish-eye lens, although other lenses may be employed. The camera **420** is angled to provide a wide field of view. The angle of the camera **420** may change depending on the anatomy of the user of the device **400**. For example, the camera **420** may be at one angle for a user with a fairly flat chest and at a different angle for a user with a fuller chest. In some implementations, the user may adjust the camera **420** manually to achieve a good angle for a wide field of view. In other implementations, the device **400** may automatically adjust the camera **420** when a new user uses the device **400**.

The right electronic enclosure **404** further includes a processor **422** with memory **424** and an IMU **426**. The processor **422** provides onboard processing for the device **400**. The processor **422** may include a connection to a communication network (e.g., a cellular network or WI-FI network). The memory **424** on the processor **422** may store information relating to the device **400**, including, without limitation, a shared map of a physical space, user settings, and user data. The processor **422** may additionally perform calculations to provide remote multi-dimensional audio to the user of the device **400**. The IMU **426** provides information about the movement of the device **400** in each dimension. The information provided by the IMU may assist the device **400** in determining its location for contribution to a shared map.

The device **400** may include additional electronic components in either the left electronic enclosure **402** or the right electronic enclosure **404**. For example, the device **400** may include, without limitation, biometric sensors, haptic feedback outputs and haptic drivers, beacons for communication with external sensors placed in a physical space, and user input components, such as buttons, switches, or touch sensors.

FIG. **5** illustrates example operations for providing multi-dimensional audio at an audio outputting device. A contributing operation **502** contributes mapping information continuously or periodically to a shared map to create a shared simulation. Each of the audio devices uses the shared map to determine the audio device's location on the shared map. Each of the audio devices then shares its location to a shared simulation. The shared simulation includes the shared infor-

mation about the location of each of the audio devices within a shared space. In one implementation, the shared simulation is created using GPS or other position sensing components in audio devices acting as the audio transmitting device and the audio outputting device. In another implementation, sensors may be placed around a physical space (e.g., a building or a room) and may communicate with beacons on the audio transmitting device and the audio outputting device. In yet another implementation, the shared map is created using cameras and orientation sensors (such as IMUs) on the audio devices. The cameras on the audio devices detect common physical points (such as corners on the walls) to create a map of the room. Such common physical points can be recognized and/or registered among multiple devices (e.g., via a mapping service) and contributed to a shared map. The orientation sensors and cameras in the audio devices provide information about how the audio devices have moved relative to the common physical points. Over time, this information is communicated to the shared map, which is used to build the shared simulation.

When the audio outputting device is ready to receive audio output, a detecting operation **504** detects an audio transmitting device within the shared simulation. Because the audio transmitting device and the audio outputting device are both continuously contributing to the shared simulation and both have access to the shared simulation, the audio outputting device may detect the location of the audio transmitting device within the shared simulation.

After the audio outputting device has detected the location of the audio transmitting device, a first determining operation **506** determines a physical location of the audio transmitting device relative to the audio outputting device using the shared simulation. The shared simulation provides the audio outputting device with information about the location of the audio transmitting device. Using that information and information about the location of the audio outputting device, the processor of the audio outputting device determines the physical location of the audio transmitting device relative to the audio outputting device.

A second determining operation **508** determines an orientation of the audio transmitting device relative to the audio outputting device. As in the first determining operation **506**, the shared map provides the audio outputting device with information about the location of the audio transmitting device. Using that information and information about the location of the audio outputting device, the processor of the audio outputting device determines the orientation of the audio transmitting device relative to the audio outputting device.

A processing operation **510** processes an audio signal received from the audio transmitting device using the determined physical location of the audio transmitting device and the orientation of the audio transmitting device to create an augmented audio signal. In some implementations, the audio outputting device may use a head-related transfer function or another method to create an augmented audio signal that makes it sound like the received audio signal is coming from a certain direction. In other implementations, the processing and calculations may occur on an external computing device communicatively connected to the audio outputting device.

An outputting operation **512** outputs the augmented audio signal through the audio output of the audio outputting device. The augmented audio signal is output differently based on the relative physical location and relative orientation of the audio transmitting device. If, for example, the audio transmitting device is located to the left of the audio outputting device, the augmented audio signal may be

output so that it is louder in the left speaker of the audio outputting device. The presentation of the augmented audio signal allows the user of the audio outputting device to determine the general direction of origination of the audio signal.

FIG. **6** illustrates an example computing device **600** for use in providing multi-dimensional audio to an audio outputting device. The example computing device **600** may be used to process audio signals remotely to provide multi-dimensional audio from the audio transmitting device to the audio outputting device. The computing device **600** may be a client device, such as a laptop, mobile device, desktop, tablet, or a server/cloud device. The computing device **600** includes one or more processor(s) **602**, and a memory **604**. The memory **604** generally includes both volatile memory (e.g., RAM) and non-volatile memory (e.g., flash memory). An operating system **610** resides in the memory **604** and is executed by the processor(s) **602**.

One or more application programs **612** modules or segments, such as a remote multi-dimensional audio engine **640** are loaded into the memory **604** and/or storage **620** and executed by the processor(s) **602**. The application programs **612** or modules may include the remote multi-dimensional audio engine **640** implemented by a shared map engine **644** and audio signal processing engine **646** which may be embodied in instructions stored in the memory **604** and/or storage **620** and executed by the processor(s) **602**. Data such as user preferences, hardware configurations, and hardware responses may be stored in the memory **604** or storage **620** and may be retrievable by the processor(s) **602** for use by the remote multi-dimensional audio engine **640**, the shared map engine **644**, and the audio signal processing engine **646**. The storage **620** may be local to the computing device **600** or may be remote and communicatively connected to the computing device **600** and may include another server. The storage **620** may store resources that are requestable by client devices (not shown).

The computing device **600** includes a power supply **616**, which is powered by one or more batteries or other power sources and which provides power to other components of the computing device **600**. The power supply **616** may also be connected to an external power source that overrides or recharges the built-in batteries or other power sources.

The computing device **600** may include one or more communication transceivers **630** which may be connected to one or more antenna(s) **632** to provide network connectivity (e.g., mobile phone network, Wi-Fi®, Bluetooth®) to one or more other servers and/or client devices (e.g., mobile devices, desktop computers, or laptop computers). The computing device **600** may further include a network adapter **636**, which is a type of communication device. The computing device **600** may use the adapter and any other types of communication devices for establishing connections over a wide-area network (WAN) or local-area network (LAN). It should be appreciated that the network connections shown are exemplary and that other communications devices and means for establishing a communications link between the computing device **600** and other devices may be used.

The computing device **600** may include one or more input devices **634** such that a user may enter commands and information (e.g., a keyboard or mouse). These and other input devices may be coupled to the server by one or more interfaces **638** such as a serial port interface, parallel port, or universal serial bus (USB). The computing device **600** may further include a display **622** such as a touchscreen display.

The computing device **600** may include a variety of tangible processor-readable storage media and intangible

processor-readable communication signals. Tangible processor-readable storage can be embodied by any available media that can be accessed by the computing device 600 and includes both volatile and nonvolatile storage media, removable and non-removable storage media. Tangible processor-readable storage media excludes intangible communications signals and includes volatile and nonvolatile, removable and non-removable storage media implemented in any method or technology for storage of information such as processor-readable instructions, data structures, program modules or other data. Tangible processor-readable storage media includes, but is not limited to, RAM, ROM, EEPROM, flash memory or other memory technology, CDROM, digital versatile disks (DVD) or other optical disk storage, magnetic cassettes, magnetic tape, magnetic disk storage or other magnetic storage devices, or any other tangible medium which can be used to store the desired information and which can be accessed by the computing device 600. In contrast to tangible processor-readable storage media, intangible processor-readable communication signals may embody processor-readable instructions, data structures, program modules or other data resident in a modulated data signal, such as a carrier wave or other signal transport mechanism. The term "modulated data signal" means a signal that has one or more of its characteristics set or changed in such a manner as to encode information in the signal. By way of example, and not limitation, intangible communication signals include signals traveling through wired media such as a wired network or direct-wired connection, and wireless media such as acoustic, RF, infrared, and other wireless media.

An example audio outputting device is provided. The audio outputting device is configured to execute a process. The process includes determining a relative physical location of an audio transmitting device relative to the audio outputting device in a shared map of a physical space, the shared map being shared between the audio transmitting device and the audio outputting device. The process further includes determining an orientation of the audio outputting device relative to the audio transmitting device and processing an audio signal received from the audio transmitting device via a communication network using the determined orientation of the audio outputting device relative to the audio transmitting device and the relative physical location of the audio transmitting device to create an augmented audio signal. The augmented audio signal is output through at least one audio output on the audio outputting device, the augmented audio signal being output in a manner that indicates a relative physical direction of the audio transmitting device to the audio outputting device in the shared map of the physical space.

An example audio outputting device of any previous audio outputting device is provided, where the augmented signal is output in a manner that further indicates the three-dimensional relative physical direction of the audio transmitting device to the audio outputting device in the shared map of the physical space.

An example audio outputting device of any previous audio outputting device is provided, where the process executed by the audio outputting device also includes selecting the audio outputting device based on its location relative to the audio transmitting device.

An example audio outputting device of any previous audio outputting device is provided, where the process executed by the audio outputting device also includes selecting the audio outputting device based on a user input received by the audio transmitting device.

An example audio outputting device of any previous audio outputting device is provided, where the audio transmitting device contributes mapping information continuously to the shared map based on information from a first position sensor located in the audio transmitting device and the audio outputting device contributes mapping information continuously to the shared map based on information from a second position sensor located in the audio outputting device.

An example audio outputting device of any previous audio outputting device is provided, where the audio transmitting device contributes mapping information continuously to the shared map based on information from a first orientation sensor located in the audio transmitting device and the audio outputting device contributes mapping information continuously to the shared map based on information from a second orientation sensor located in the audio outputting device.

An example audio outputting device of any previous audio outputting device is provided, where the shared map is created by information received from external sensors, the external sensors being in communication with the audio transmitting device and the audio outputting device.

An example method includes determining a relative physical location of an audio transmitting device relative to an audio outputting device in a shared map of a physical space, the shared map being shared between the audio transmitting device and the audio outputting device. The method also includes determining an orientation of the audio outputting device relative to the audio transmitting device and processing an audio signal received from the audio transmitting device via a communication network using the determined orientation of the audio outputting device relative to the audio transmitting device and the relative physical location of the audio transmitting device to create an augmented audio signal. The method also outputs the augmented audio signal through at least one audio output on the audio outputting device, the augmented audio signal being output in a manner that indicates a relative physical direction of the audio transmitting device to the audio outputting device in the shared map of the physical space.

An example method of any previous method is provided, where the augmented signal is output in a manner that further indicates the three-dimensional relative physical direction of the audio transmitting device to the audio outputting device in the shared map of the physical space.

An example method of any previous method further includes selecting the audio outputting device based on its position relative to the position and orientation of the audio transmitting device.

An example method of any previous method further includes selecting the audio outputting device based on a user input received by the audio transmitting device.

An example method of any previous method is provided, where the audio transmitting device contributes mapping information continuously to the shared map based on information from a first position sensor located in the audio transmitting device and the audio outputting device contributes mapping information continuously to the shared map based on information from a second position sensor located in the audio outputting device.

An example method of any previous method is provided, where the audio transmitting device contributes mapping information continuously to the shared map based on information from a first orientation sensor located in the audio transmitting device and the audio outputting device contributes mapping information continuously to the shared map

based on information from a second orientation sensor located in the audio outputting device.

An example method of any previous method is provided, where the shared map is created by information received from external sensors, the external sensors being in communication with the audio transmitting device and the audio outputting device.

An example system includes means for determining a relative physical location of an audio transmitting device relative to an audio outputting device in a shared map of a physical space, the shared map being shared between the audio transmitting device and the audio outputting device. The system also includes means for determining an orientation of the audio outputting device relative to the audio transmitting device and processing an audio signal received from the audio transmitting device via a communication network using the determined orientation of the audio outputting device relative to the audio transmitting device and the relative physical location of the audio transmitting device to create an augmented audio signal. The system also includes means for outputting the augmented audio signal through at least one audio output on the audio outputting device, the augmented audio signal being output in a manner that indicates a relative physical direction of the audio transmitting device to the audio outputting device in the shared map of the physical space.

An example system of any preceding system is provided, where the augmented signal is output in a manner that further indicates a three-dimensional relative physical direction of the audio transmitting device to the audio outputting device in the shared map of the physical space.

An example system of any preceding system includes means for selecting the audio outputting device based on its position relative to the position and orientation of the audio transmitting device.

An example system of any preceding system is provided, where the audio transmitting device contributes mapping information continuously to the shared map based on information from a first position sensor located in the audio transmitting device and the audio outputting device contributes mapping information continuously to the shared map based on information from a second position sensor located in the audio outputting device.

An example system of any preceding system is provided, where the audio transmitting device contributes mapping information continuously to the shared map based on information from a first orientation sensor located in the audio transmitting device and the audio outputting device contributes mapping information continuously to the shared map based on information from a second orientation sensor located in the audio outputting device.

An example system of any preceding system is provided, where the shared map is created by information received from external sensors, the external sensors being in communication with the audio transmitting device and the audio outputting device.

Example one or more tangible processor-readable storage media are embodied with instructions for executing on one or more processors and circuits of a computing device a process including determining a relative physical location of an audio transmitting device relative to an audio outputting device in a shared map of a physical space, the shared map being shared between the audio transmitting device and the audio outputting device. The process further includes determining an orientation of the audio outputting device relative to the audio transmitting device. The process further includes processing an audio signal received from the audio

transmitting device via a communication network using the determined orientation of the audio outputting device relative to the audio transmitting device and the relative physical location of the audio transmitting device to create an augmented audio signal. The process further includes outputting the augmented audio signal through at least one audio output on the audio outputting device, the augmented audio signal being output in a manner that indicates a relative physical direction of the audio transmitting device to the audio outputting device in the shared map of the physical space.

Another example one or more tangible processor-readable storage media are embodied with instructions for executing on one or more processors and circuits of a device a process of any preceding process, further including selecting the audio outputting device based on its position relative to the position and orientation of the audio transmitting device.

Another example one or more tangible processor-readable storage media are embodied with instructions for executing on one or more processors and circuits of a device a process of any preceding process, further including selecting the audio outputting device based on a user input received by the audio transmitting device.

Another example one or more tangible processor-readable storage media are embodied with instructions for executing on one or more processors and circuits of a device a process of any preceding process where the audio transmitting device contributes mapping information continuously to the shared map based on information from a first position sensor located in the audio transmitting device and the audio outputting device contributes mapping information continuously to the shared map based on information from a second position sensor located in the audio outputting device.

Another example one or more tangible processor-readable storage media are embodied with instructions for executing on one or more processors and circuits of a device a process of any preceding process where the audio transmitting device contributes mapping information continuously to the shared map based on information from a first orientation sensor located in the audio transmitting device and the audio outputting device contributes mapping information continuously to the shared map based on information from a second orientation sensor located in the audio outputting device.

Another example one or more tangible processor-readable storage media are embodied with instructions for executing on one or more processors and circuits of a device a process of any preceding process where the shared map is created by information received from external sensors, the external sensors being in communication with the audio transmitting device and the audio outputting device.

Some implementations may comprise an article of manufacture. An article of manufacture may comprise a tangible storage medium to store logic. Examples of a storage medium may include one or more types of computer-readable storage media capable of storing electronic data, including volatile memory or non-volatile memory, removable or non-removable memory, erasable or non-erasable memory, writeable or re-writable memory, and so forth. Examples of the logic may include various software elements, such as software components, programs, applications, computer programs, application programs, system programs, machine programs, operating system software, middleware, firmware, software modules, routines, subroutines, operation segments, methods, procedures, software interfaces, application program interfaces (API), instruction sets, computing code, computer code, code segments, computer code segments, words, values, symbols, or any combination thereof. In one implementation, for example, an

article of manufacture may store executable computer program instructions that, when executed by a computer, cause the computer to perform methods and/or operations in accordance with the described embodiments. The executable computer program instructions may include any suitable type of code, such as source code, compiled code, interpreted code, executable code, static code, dynamic code, and the like. The executable computer program instructions may be implemented according to a predefined computer language, manner or syntax, for instructing a computer to perform a certain operation segment. The instructions may be implemented using any suitable high-level, low-level, object-oriented, visual, compiled and/or interpreted programming language.

The implementations described herein are implemented as logical steps in one or more computer systems. The logical operations may be implemented (1) as a sequence of processor-implemented steps executing in one or more computer systems and (2) as interconnected machine or circuit modules within one or more computer systems. The implementation is a matter of choice, dependent on the performance requirements of the computer system being utilized. Accordingly, the logical operations making up the implementations described herein are referred to variously as operations, steps, objects, or modules. Furthermore, it should be understood that logical operations may be performed in any order, unless explicitly claimed otherwise or a specific order is inherently necessitated by the claim language.

What is claimed is:

1. An audio outputting device configured to execute a process comprising:

determining a relative physical location of an audio transmitting device relative to the audio outputting device in a shared map of a physical space, the shared map being shared between the audio transmitting device and the audio outputting device;

determining an orientation of an axis of the audio outputting device relative to the audio transmitting device; processing an audio signal received from the audio transmitting device via a communication network using the determined orientation of the axis of the audio outputting device relative to the audio transmitting device and the relative physical location of the audio transmitting device to create an augmented audio signal; and

outputting the augmented audio signal through at least one audio output on the audio outputting device, the augmented audio signal being output in a manner that indicates a relative physical direction of the audio transmitting device to the audio outputting device in the shared map of the physical space.

2. The audio outputting device of claim 1, wherein the augmented audio signal is output in a manner that further indicates a three-dimensional relative physical direction of the audio transmitting device to the audio outputting device in the shared map of the physical space.

3. The audio outputting device of claim 1, the process further comprising:

selecting the audio outputting device based on its location relative to the audio transmitting device.

4. The audio outputting device of claim 1, the process further comprising:

selecting the audio outputting device based on a user input received by the audio transmitting device.

5. The audio outputting device of claim 1, wherein the audio transmitting device contributes mapping information continuously to the shared map based on information from

a first position sensor located in the audio transmitting device and the audio outputting device contributes mapping information continuously to the shared map based on information from a second position sensor located in the audio outputting device.

6. The audio outputting device of claim 1, wherein the audio transmitting device contributes mapping information continuously to the shared map based on information from a first orientation sensor located in the audio transmitting device and the audio outputting device contributes mapping information continuously to the shared map based on information from a second orientation sensor located in the audio outputting device.

7. The audio outputting device of claim 1, wherein the shared map is created by information received from external sensors, the external sensors being in communication with the audio transmitting device and the audio outputting device.

8. The audio outputting device of claim 1, wherein the augmented audio signal is output in a manner that further indicates the determined orientation of the axis of the audio outputting device to the audio transmitting device in the shared map of the physical space.

9. A method comprising:

determining a relative physical location of an audio transmitting device relative to an audio outputting device in a shared map of a physical space, the shared map being shared between the audio transmitting device and the audio outputting device;

determining an orientation of an axis of the audio outputting device relative to the audio transmitting device; processing an audio signal received from the audio transmitting device via a communication network using the determined orientation of the axis of the audio outputting device relative to the audio transmitting device and the relative physical location of the audio transmitting device to create an augmented audio signal; and

outputting the augmented audio signal through at least one audio output on the audio outputting device, the augmented audio signal being output in a manner that indicates a relative physical direction of the audio transmitting device to the audio outputting device in the shared map of the physical space.

10. The method of claim 9, wherein the augmented audio signal is output in a manner that further indicates a three-dimensional relative physical direction of the audio transmitting device to the audio outputting device in the shared map of the physical space.

11. The method of claim 9, further comprising:

selecting the audio outputting device based on its location relative to the location and orientation of the axis of the audio transmitting device.

12. The method of claim 9, further comprising:

selecting the audio outputting device based on a user input received by the audio transmitting device.

13. The method of claim 9, wherein the audio transmitting device contributes mapping information continuously to the shared map based on information from a first position sensor located in the audio transmitting device and the audio outputting device contributes mapping information continuously to the shared map based on information from a second position sensor located in the audio outputting device.

14. The method of claim 9, wherein the audio transmitting device contributes mapping information continuously to the shared map based on information from a first orientation sensor located in the audio transmitting device and the audio outputting device contributes mapping information continu-

17

ously to the shared map based on information from a second orientation sensor located in the audio outputting device.

15. The method of claim 9, wherein the shared map is created by information received from external sensors, the external sensors being in communication with the audio transmitting device and the audio outputting device.

16. One or more tangible processor-readable storage media embodied with instructions for executing on one or more processors and circuits of a computing device a process comprising:

determining a relative physical location of an audio transmitting device relative to an audio outputting device in a shared map of a physical space, the shared map being shared between the audio transmitting device and the audio outputting device;

determining an orientation of an axis of the audio outputting device relative to the audio transmitting device;

processing an audio signal received from the audio transmitting device via a communication network using the determined orientation of the axis of the audio outputting device relative to the audio transmitting device and the relative physical location of the audio transmitting device to create an augmented audio signal; and

outputting the augmented audio signal through at least one audio output on the audio outputting device, the augmented audio signal being output in a manner that indicates a relative physical direction of the audio transmitting device to the audio outputting device in the shared map of the physical space.

17. The one or more tangible processor-readable storage media of claim 16, wherein the process further comprises:

18

selecting the audio outputting device based on its location relative to the location and orientation of the axis of the audio transmitting device.

18. The one or more tangible processor-readable storage media of claim 16, wherein the process further comprises:

selecting the audio outputting device based on a user input received by the audio transmitting device.

19. The one or more tangible processor-readable storage media of claim 16, wherein the audio transmitting device contributes mapping information continuously to the shared map based on information from a first position sensor located in the audio transmitting device and the audio outputting device contributes mapping information continuously to the shared map based on information from a second position sensor located in the audio outputting device.

20. The one or more tangible processor-readable storage media of claim 16, wherein the audio transmitting device contributes mapping information continuously to the shared map based on information from a first orientation sensor located in the audio transmitting device and the audio outputting device contributes mapping information continuously to the shared map based on information from a second orientation sensor located in the audio outputting device.

21. The one or more tangible processor-readable storage media of claim 16, wherein the shared map is created by information received from external sensors, the external sensors being in communication with the audio transmitting device and the audio outputting device.

* * * * *